



HEALTHCARE/ LAB EQUIPMENT BROCHURE 2020

Shelving - Racks - Carts - Tables - Sinks

spgusa.com



NSF

SPG's foodservice products
are all manufactured to
meet NSF standards. For
specific items, visit
www.nsf.org

Get to know the **8** **Product Lines** of SPG

The SPG name has only been around since 2010, however the product lines that comprise our company have been among the most well-known and respected names in the foodservice business for nearly six decades. Individually, each of the product lines below brings unique expertise, capabilities and quality to foodservice operations. Together, they offer you a total turnkey solution.

AMCO®: The industry leader in premium shelving, equipment and accessories that utilize an ultra-strong square-post system.

ISS™: Strong, versatile wire-based shelving, wall storage systems, carts, racks, dollies, workstations and more.

ISS Contender™: The industry's workhorse in wire shelving and accessories — the ideal choice for general applications.

Freestyle®: Strong, versatile and space-efficient, Freestyle® freestanding cantilever shelving and workstations provide maximum performance for every area of your operations.

Kelmax®: The gold standard in aluminum equipment — from storage and transport to specialty items for everything from produce and bakery to material handling.

Universal® Stainless: The stainless steel fabrication specialists — offering a vast array of sinks, tables, cabinets, shelves, racks, stands, counters and more.

Gillis® & Jarke®: SPG's two material handling lines deliver equipment that's tough, durable, innovative, efficient and economical.

There are opportunities everywhere in your operation. **We'll help you find them.**

While we are happy to sell a customer a single piece of equipment, the real value we provide is our ability to analyze your operation and design a comprehensive solution customized to your unique needs. Working with you, we'll help you uncover the hidden opportunities that exist in your facilities. Then, we'll help you select the right systems and integrate them into your operation in a way that increases workflow, maximizes storage capacity, improves employee productivity, cuts costs and increases profitability.

We can offer you these services because SPG manufactures the widest selection of equipment solutions on the market. And, we match that selection with years of proven experience.

Our comprehensive product selection can provide an integrated system that encompasses every facet of your operations. From the backroom to the bakery to the bar...from the drive-thru to the dish and dry storage areas...we'll put together the equipment — and a comprehensive plan — that will help you maximize the efficiency and performance of your business.

AMCO® Plastic Plus® & Plasteel® Shelving



AMCO® Plastic Plus® Shelving

- Grey polypropylene plastic removable panels easily snap onto heavy duty epoxy coated frames
- Sectional panels can be easily removed from frames for cleaning — no tools or hardware required
- An antimicrobial agent protects the finish from bacteria, mold, mildew and fungi that cause odors, stains and product degradation*
- For all environments from -20°F (-29°C) to 190°F (88°C)
- Strength rated to support 1,000 lbs. (455kg) of uniformly loaded static weight per shelf
- Fits standard AMCO® square posts and is compatible with other AMCO® shelving products
- Stainless steel posts recommended for a rust-free solution

* This product does not protect users or others against bacteria, viruses, germs or other disease organisms. It is for the protection of the product only. This antimicrobial product should always be thoroughly cleaned after each use.

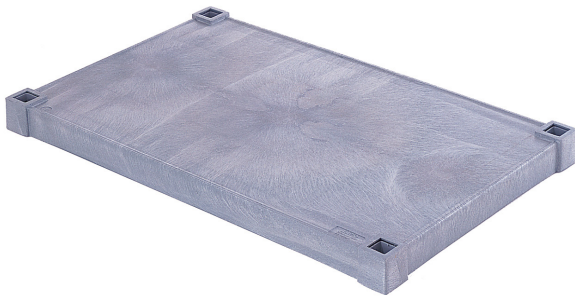

AMCO® Plasteel® Shelving

- Steel-reinforced plastic shelves support 1,000 lbs. each
- Available in solid or vented style — solid style has raised edge to contain liquid spills
- Grey high-impact structural foam plastic
- May be used with all other styles of Amco® shelves
- Solid style accepted by the United States Department of Agriculture for direct food contact
- Stainless steel post recommended since it never rusts

AMCO® Plastic Plus Shelves		WIDTH	
		18	24
LENGTH	36	PP1836*	PP2436*
	42	PP1842*	PP2442*
	48	PP1848*	PP2448*
	54	PP1854*	PP2454*
	60	PP1860*	PP2460*

AMCO® Plasteel Shelves		WIDTH	
		18	24
LENGTH	30	PS1830*	PS2430*
	36	PS1836*	PS2436*
	48	PS1848*	PS2448*
	60	PS1860*	PS2460*

* Available Models	
Vented	V
Solid	S

ISS® Wire Shelving



- Durable round post system is interchangeable with other manufacturers' shelving products
- Ideal for most any environment
- Shelves up to 60" long are rated to support 1,250 lbs. of uniformly distributed static weight
- Shelves feature extra trusses for a higher load rating, less deflection and the ability to use longer shelves
- Posts are numbered on 1" increments to speed assembly and ensure more precise shelf alignment
- Our one-piece hinged Sure-Lock™ coupler makes assembly easy and improves stability
- Shelves are available in wire, dunnage, Series 300 solid stainless steel and plastic
- Marine waterfall shelf edge allows easy loading and unloading



ISS® Shelves		WIDTH					
		14	18	21	24	30	36
LENGTH	24	1424*	1824*	2124*	2424*	3024*	3624*
	30	1430*	1830*	2130*	2430*	3030*	3630*
	36	1436*	1836*	2136*	2436*	3036*	3636*
	42	1442*	1842*	2142*	2442*	3042*	3642*
	48	1448*	1848*	2148*	2448*	3048*	3648*
	54	1454*	1854*	2154*	2454*	3054*	3654*
	60	1460*	1860*	2160*	2460*	3060*	3660*
	66	1466*	1866*	2166*	2466*	3066*	3666*
	72	1472*	1872*	2172*	2472*	3072*	3672*

ISS® Posts		TYPE	
		Stationary	Mobile
LENGTH	14	P14*	P14N*
	34	P34*	P34N*
	36	P36*	P36N*
	54	P54*	P54N*
	62	P62*	P62N*
	74	P74*	P74N*
	86	P86*	P86N*

ISS® Support Posts		
LENGTH	31	P31Y
	34	P34Y

ISS® Stainless Steel Shelves		WIDTH	
		18	24
LENGTH	30	1830FSW	2430FSW
	36	1836FSW	2436FSW
	42	1842FSW	2442FSW
	48	1848FSW	2448FSW

ISS® Inverted Shelves		WIDTH	
		18	24
LENGTH	24	1824IS*	2424IS*
	30	1830IS*	2430IS*
	36	1836IS*	2436IS*
	48	1848IS*	2448IS*

ISS® Split Posts		
LENGTH	70	P570*

Post Available Finishes	
Plated	C
Gold Bond	Y
Grey Bond	E
Stainless Steel	S

Shelf Available Finishes	
Plated	C
Gold Bond	Y
Grey Bond	E

ISS Contender® Shelving

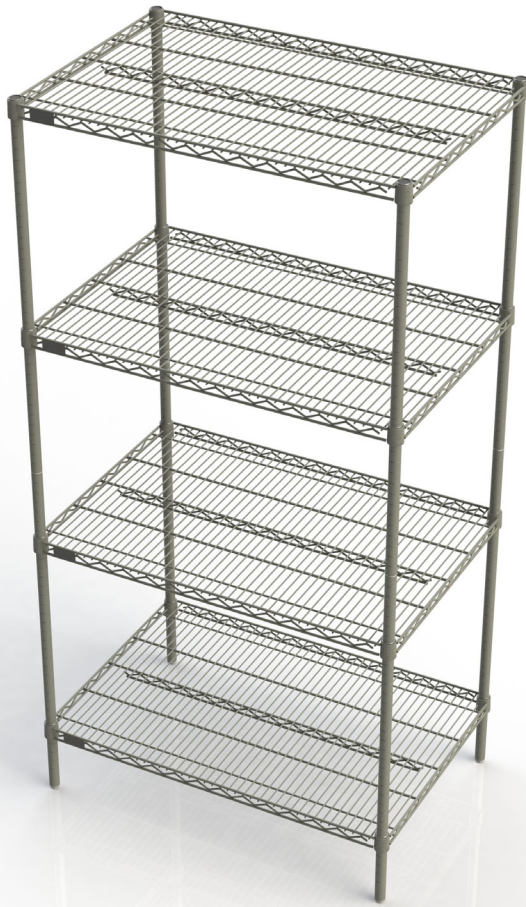

- ISS Contender™ round post shelving is a strong, economical solution for both dry and refrigerated storage needs
- Available with Plating Plus™ finish for display and dry environments — or Contender Grey™ Epoxy finish which is warranted for seven years against naturally occurring corrosion in high-moisture, high-humidity environments
- Each 48" shelf is rated to support up to 800 lbs. (363 kgs) of uniformly distributed static load weight — longer shelves can support up to 600 lbs. (272 kgs)
- Assembles in minutes without tools or hardware
- Shelves are installed on the posts in 1" (25mm) increments — and can be changed easily as storage needs change

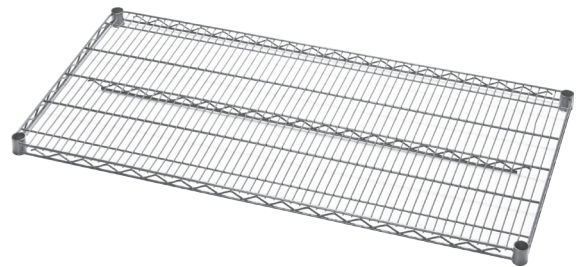

ISS CONTENDER®		WIDTH		
Shelves		14	18	24
LENGTH	30	IC1430*	IC1830*	IC2430*
	36	IC1436*	IC1836*	IC2436*
	42	IC1442*	IC1842*	IC2442*
	48	IC1448*	IC1848*	IC2448*
	54	IC1454*	IC1854*	IC2454*
	60	IC1460*	IC1860*	IC2460*
	72	IC1472*	IC1872*	IC2472*

* Available Finishes	
Plated Plus®	C
Contender Grey®	CG

ISS CONTENDER®		TYPE	
Posts		Stationary	Mobile
LENGTH	34	IC034*	IC034NF*
	54	IC054*	IC054NF*
	64	IC064*	IC064NF*
	72	IC072*	IC072NF*
	84	IC084*	IC084NF*

AMCO® Mod-A-Flex® Shelving



- Designed for walk-in coolers and freezers
- Ceiling mounted — no need to reinforce side walls
- Boosts capacity by up to 30% with the freedom to adjust shelves to the height of the product being stored
- No posts on the floor make cleaning easy
- Shelves can be removed without tools for cleaning
- Easy and fast adjustment of shelves; simply slide the shelf sideways to lift out of current location
- Antimicrobial grey epoxy coating for maximum cleanliness and moisture resistance

Every detail of the Mod-A-Flex® system is designed to improve employee efficiency, productivity and speed of service — reducing labor and storage costs while contributing to overall operational results.

Mod-A-Flex® not only increases storage capacity up to 30% ... it also offers greater organization and higher visibility of stock... shelves can also be quickly and easily removed and repositioned...and because there are no posts, cleaning the floor is faster, easier and more thorough.

Mod-A-Flex - Standard Shelves		WIDTH		
		12	18	21
LENGTH	24	MX1224GR	MX1824GR	MX2424GR
	30	MX1230GR	MX1830GR	MX2430GR
	36	MX1236GR	MX1836GR	MX2436GR
	42	MX1242GR	MX1842GR	MX2442GR
	48	MX1248GR	MX1848GR	MX2448GR
	60	MX1260GR	MX1860GR	MX2460GR

Mod-A-Flex - Aluminum Shelves		WIDTH	
		18	21
LENGTH	24	MXSV1824A	MXSV2424A
	30	MXSV1830A	MXSV2430A
	36	MXSV1836A	MXSV2436A
	42	MXSV1842A	MXSV2442A
	48	MXSV1848A	MXSV2448A
	60	MXSV1860A	MXSV2460A

MOD-A-FLEX WALL UPRIGHTS		
LENGTH	18	MXD18GR
	36	MXD36GR
	72	MXD72GR
	85	MXD85GR

MOD-A-FLEX UPRIGHT EXTENDERS		
LENGTH	15	MXEXT15GR
	26	MXEXT26GR
	36	MXEXT36GR

MOD-A-FLEX HANGING UPRIGHTS		
LENGTH	36	MX36GR
	40	MX40GR
	61	MX61GR
	72	MX72GR
	81	MX81GR
	99	MX99GR

ISS® Wall-Trax® Shelving



ISS™ Wall Trax™ is a complete wall mounted storage solution with specially engineered aluminum channel and grid system to increase efficiency and expand storage capacity.

- ISS™ Wall Trax™ channels and grids are easy to install
- Easily attach accessories without the need for tools or hardware
- All shelves can be moved by simply unhooking from grid or channel
- Available in three finishes, all corrosion-resistant, epoxy-based polymer coated: Grey Bond®, Gold Bond® and Black

Flat Grid		HEIGHT		
		24	36	48
LENGTH	24	GRWM2424*		
	36	GRWM2436*	GRWM3636*	
	48	GRWM2448*	GRWM3648*	GRWM4848*
	60		GRWM3660*	

Offset Grid		HEIGHT		
		20	24	40
LENGTH	24		GRO2424*	
	36	GRO2036*	GRO2436*	
	48	GRO2048*	GRO2448*	GRO4048*

Wall Trax Channels		
Length	18	TRAX18A
	24	TRAX2A
	42	TRAX42APD
	48	TRAX4A
	50	WENTRAXAPD
	60	TRAX5A
	96	TRAX8A

Grid Available Finishes	
Gold Bond	Y
Grey	E
Stainless Steel	S
Black (GRWM Only)	BLK

Grid Baskets
GB12106*
GB12186*
GB12246*
GB18143*
GB3420*
GB4512*
GB6186*
GB994*

Grid Shelves			WIDTH	
LENGTH	Type	LENGTH	14	18
	GS	24	GS1424*	GS1824*
	GS	36	GS1436*	GS1836*
	GS	48	GS1448*	GS1848*
	GSS	24	GSS1424*	GSS1824*
	GSS	36	GSS1436*	GSS1836*
	GSS	48	GSS1448*	GSS1848*
	GSL	24	GSL1424*	GSL1824*
	GSL	36	GSL1436*	GSL1836*
	GSL	48	GSL1448*	GSL1848*

Grid Shelf Available Finishes	
Gold Bond	Y
Grey	E
Stainless Steel	S

Stationary & Mobile Security Units

AMCO® Security Shelving

- Lockable wire enclosure limits opportunities to steal, reducing losses due to theft
- Provides a secure area with adjustable shelving for storage of costly items that tend to disappear
- 2"x 2" wire-spacing prevents small goods from being removed
- Door secures at both top and bottom, and handle has hasp design so it can be padlocked (padlock not included)
- Shelves and posts may be ordered in any available finish — enclosure available in Plating Plus™ finish only
- Available in stationary and mobile models — choose from a variety of standard caster offerings

Stationary Models	Mobile Models	Dimensions
SU1300CP	SU1172CPMO	18 x 48 x 72
SU1316CP	SU1188CPMO	24 x 48 x 72
SU1302CP	SU1174CPMO	18 x 60 x 72
SU1318CP	SU1190CPMO	24 x 60 x 72



ISS™ Stationary Security Units

- Includes 4 posts, top and bottom shelves, 2 side panels, 2 back panels and 2 lockable front doors
- Order intermediate shelves separately

Plating Plus™	Gold Bond®	W x L x H
SR536C	SR536Y	24 x 36 x 68
SR548C	SR548Y	24 x 48 x 68
SR560C	SR560Y	24 x 60 x 68

ISS™ Mobile Security Trucks

- Standard Security Trucks include:
4 posts; top and bottom shelves; 2 side panels; 2 back panels; 2 lockable front doors; 4 5" resilient stem swivel casters, 4 bumpers — order intermediate shelves separately

Heavy Duty Security Trucks include a dolly frame with wraparound bumpers and 5" resilient plate casters

Plating Plus™	Gold Bond®	W x L x H
Standard		
SS536C	SS536Y	24 x 36 x 68
SS548C	SS548Y	24 x 48 x 68
SS560C	SS560Y	24 x 60 x 68
Heavy Duty		
SH536C	SH536Y	24 x 36 x 68
SH548C	SH548Y	24 x 48 x 68
SH560C	SH560Y	24 x 60 x 68

Freestyle® Workstation



- The ergonomic design maximizes usable kitchen space and provides added storage for packaging, smallwares, menus, ingredients, utensils and more
- An impressive total load-bearing capacity of 2,800 lbs.
 - each upper shelf has a 600-lb. capacity
 - bottom shelf capacity is 1,000 lbs.
- Plug and place steamers, microwaves, food warmers and other standard equipment
- Fast, easy cleaning of food prep surfaces and overall structure
- 30" deep stainless steel work surface provides plenty of area for prep work
- Open-base design delivers adequate space for a fridge under the work surface of the 48", 54" and 60" models
- Shelf and work surface heights adjust in 2" increments
- Add components or shelves without tools
- No front uprights for an uninterrupted work surface

Before you choose a workstation, consider why so many major national foodservice operations have turned to Freestyle® to improve storage, efficiency and productivity.

Freestyle® combines the versatility and flexibility of a freestanding unit while providing rock-solid strength and stability to support steamers, microwaves and other vital equipment

From the ability to add or reconfigure shelves quickly and without tools to the wide selection of accessories available – everything about Freestyle® is customizable.

Unlike most competitive units, Freestyle® doesn't require a bottom shelf for stability – freeing up floor space underneath for a refrigerator at a prep station or a safe at the Drive-Thru.

Storage is enhanced by virtue of a 2,800-lb. unit capacity...shelves that can be positioned in 2" increments...and shelf surface areas that are uninterrupted by front uprights.

Model #	Prep Surface Widths	Lengths	Inside Clearance
WST1491E	30"	60"	56"
WST1539E	30"	54"	50"
WST1492E	30"	48"	44"
WST1493E	30"	36"	32"

Transport Carts

Kelmax Produce Stocking Cart

- Versatile 2-tier high-capacity design
- Heavy duty galvanized solid top shelf (22" x 44")
- Galvanized square tube bottom shelf
- 5" polyurethane plate casters; 2 swivel and 2 rigid

Kelmax Produce Cart		WIDTH
		22
LENGTH	40	4G0189
	44	4G0172



Kelmax U-Boat

- Heavy-duty dual steel channel base deck
- 6-wheel design offers maximum maneuverability
- 2 - 8" rigid center polyurethane wheels
- 4 - 4" swivel polyurethane end casters
- One U-Boat does the work of five (5) hand trucks
- 24" deck is available when a larger capacity is needed

Kelmax U-Boats		WIDTH	
		16	18
LENGTH	60	4G0251*	4G0263

*Diamond Tread



Kelmax Heavy-Duty Stainless Steel Utility Cart

- A reinforced tube adds strength under front lip of shelves
- 5" x 2" polyurethane plate casters
- 1,100 lb-rolling capacity
- Stainless steel caster hardware
- Made in 304 Series stainless steel for rust resistance

Kelmax Stainless Carts		TIERS	
		2	3
LENGTH x WIDTH	33 x 21	4J0497*	4J0504*
	49 x 21	4J0204	4J0207
			4J0217

*Economy Line



Universal® Flat-Top Stainless Tables

- Choose from two series of tables:
Standard N Series: 16-gauge 300 Series stainless steel top
Spec SL Line: 14-gauge 300 Series stainless steel top
- Square edge design for clean abutment to other equipment
- Legs: 1-5/8" O.D. 16-gauge stainless steel with adjustable bullet feet and stainless steel gussets
- Crossrails: 1-5/8" O.D. 16-gauge stainless steel notched to fit legs and fully welded
- Undershelves: 18-gauge stainless steel with corners notched to fit legs and fully welded
- Standard working height is 36"
- All tables 84" and longer come standard with 6 legs
- Ships welded and set up - no assembly required



UNIVERSAL WORK TABLES FLAT TOP 16GA CROSSRAILS		WIDTH		
		24	30	36
LENGTH	24	2SLC-24*	2SLC-30*	2SLC-36*
	30	30SLC-24*	30*SLC-30*	30SLC-36*
	36	3SLC-24*	3SLC-30*	3SLC-36*
	48	4SLC-24*	4SLC-30*	4SLC-36*
	60	5SLC-24*	5SLC-30*	5SLC-36*
	72	6SLC-24*	6SLC-30*	6SLC-36*
	84	7SLC-24*	7SLC-30*	7SLC-36*
	96	8SLC-24*	8SLC-30*	8SLC-36*
	108	9SLC-24*	9SLC-30*	9SLC-36*
	120	10SLC-24*	10SLC-30*	10SLC-36*

UNIVERSAL WORK TABLES FLAT TOP 14GA CROSSRAILS		WIDTH		
		24	30	36
LENGTH	24	2-SL-SLC-24*	2-SL-SLC-30*	2-SL-SLC-36*
	30	30-SL-SLC-24*	30-SL-SLC-30*	30-SL-SLC-36*
	36	3-SL-SLC-24*	3-SL-SLC-30*	3-SL-SLC-36*
	48	4-SL-SLC-24*	4-SL-SLC-30*	4-SL-SLC-36*
	60	5-SL-SLC-24*	5-SL-SLC-30*	5-SL-SLC-36*
	72	6-SL-SLC-24*	6-SL-SLC-30*	6-SL-SLC-36*
	84	7-SL-SLC-24*	7-SL-SLC-30*	7-SL-SLC-36*
	96	8-SL-SLC-24*	8-SL-SLC-30*	8-SL-SLC-36*
	108	9-SL-SLC-24*	9-SL-SLC-30*	9-SL-SLC-36*
	120	10-SL-SLC-24*	10-SL-SLC-30*	10-SL-SLC-36*

UNIVERSAL WORK TABLES FLAT TOP 16GA UNDERSHELF		WIDTH		
		24	30	36
LENGTH	24	2SLS-24*	2SLS-30*	2SLS-36*
	30	30SLS-24*	30*SLS-30*	30SLS-36*
	36	3SLS-24*	3SLS-30*	3SLS-36*
	48	4SLS-24*	4SLS-30*	4SLS-36*
	60	5SLS-24*	5SLS-30*	5SLS-36*
	72	6SLS-24*	6SLS-30*	6SLS-36*
	84	7SLS-24*	7SLS-30*	7SLS-36*
	96	8SLS-24*	8SLS-30*	8SLS-36*
	108	9SLS-24*	9SLS-30*	9SLS-36*
	120	10SLS-24*	10SLS-30*	10SLS-36*

UNIVERSAL WORK TABLES FLAT TOP 14GA UNDERSHELF		WIDTH		
		24	30	36
LENGTH	24	2-SL-SLS-24*	2-SL-SLS-30*	2-SL-SLS-36*
	30	30-SL-SLS-24*	30-SL-SLS-30*	30-SL-SLS-36*
	36	3-SL-SLS-24*	3-SL-SLS-30*	3-SL-SLS-36*
	48	4-SL-SLS-24*	4-SL-SLS-30*	4-SL-SLS-36*
	60	5-SL-SLS-24*	5-SL-SLS-30*	5-SL-SLS-36*
	72	6-SL-SLS-24*	6-SL-SLS-30*	6-SL-SLS-36*
	84	7-SL-SLS-24*	7-SL-SLS-30*	7-SL-SLS-36*
	96	8-SL-SLS-24*	8-SL-SLS-30*	8-SL-SLS-36*
	108	9-SL-SLS-24*	9-SL-SLS-30*	9-SL-SLS-36*
	120	10-SL-SLS-24*	10-SL-SLS-30*	10-SL-SLS-36*

SUFFIX	DESCRIPTION
-C	Casters

Universal® Backsplash Stainless Tables



UNIVERSAL WORK TABLES BACKSPLASH 16GA CROSSRAILS		WIDTH		
		24	30	36
LENGTH	24	2SLCB-24*	2SLCB-30*	2SLCB-36*
	30	30SLCB-24*	30*SLCB-30*	30SLCB-36*
	36	3SLCB-24*	3SLCB-30*	3SLCB-36*
	48	4SLCB-24*	4SLCB-30*	4SLCB-36*
	60	5SLCB-24*	5SLCB-30*	5SLCB-36*
	72	6SLCB-24*	6SLCB-30*	6SLCB-36*
	84	7SLCB-24*	7SLCB-30*	7SLCB-36*
	96	8SLCB-24*	8SLCB-30*	8SLCB-36*
	108	9SLCB-24*	9SLCB-30*	9SLCB-36*
	120	10SLCB-24*	10SLCB-30*	10SLCB-36*

UNIVERSAL WORK TABLES BACKSPLASH 14GA CROSSRAILS		WIDTH		
		24	30	36
LENGTH	24	2-SL-SLCB-24*	2-SL-SLCB-30*	2-SL-SLCB-36*
	30	30-SL-SLCB-24*	30*-SL-SLCB-30*	30-SL-SLCB-36*
	36	3-SL-SLCB-24*	3-SL-SLCB-30*	3-SL-SLCB-36*
	48	4-SL-SLCB-24*	4-SL-SLCB-30*	4-SL-SLCB-36*
	60	5-SL-SLCB-24*	5-SL-SLCB-30*	5-SL-SLCB-36*
	72	6-SL-SLCB-24*	6-SL-SLCB-30*	6-SL-SLCB-36*
	84	7-SL-SLCB-24*	7-SL-SLCB-30*	7-SL-SLCB-36*
	96	8-SL-SLCB-24*	8-SL-SLCB-30*	8-SL-SLCB-36*
	108	9-SL-SLCB-24*	9-SL-SLCB-30*	9-SL-SLCB-36*
	120	10-SL-SLCB-24*	10-SL-SLCB-30*	10-SL-SLCB-36*

UNIVERSAL WORK TABLES BACKSPLASH 16GA UNDERSHELF		WIDTH		
		24	30	36
LENGTH	24	2SLSB-24*	2SLSB-30*	2SLSB-36*
	30	30SLSB-24*	30*SLSB-30*	30SLSB-36*
	36	3SLSB-24*	3SLSB-30*	3SLSB-36*
	48	4SLSB-24*	4SLSB-30*	4SLSB-36*
	60	5SLSB-24*	5SLSB-30*	5SLSB-36*
	72	6SLSB-24*	6SLSB-30*	6SLSB-36*
	84	7SLSB-24*	7SLSB-30*	7SLSB-36*
	96	8SLSB-24*	8SLSB-30*	8SLSB-36*
	108	9SLSB-24*	9SLSB-30*	9SLSB-36*
	120	10SLSB-24*	10SLSB-30*	10SLSB-36*

UNIVERSAL WORK TABLES BACKSPLASH 14GA UNDERSHELF		WIDTH		
		24	30	36
LENGTH	24	2-SL-SLSB-24*	2-SL-SLSB-30*	2-SL-SLSB-36*
	30	30-SL-SLSB-24*	30*-SL-SLSB-30*	30-SL-SLSB-36*
	36	3-SL-SLSB-24*	3-SL-SLSB-30*	3-SL-SLSB-36*
	48	4-SL-SLSB-24*	4-SL-SLSB-30*	4-SL-SLSB-36*
	60	5-SL-SLSB-24*	5-SL-SLSB-30*	5-SL-SLSB-36*
	72	6-SL-SLSB-24*	6-SL-SLSB-30*	6-SL-SLSB-36*
	84	7-SL-SLSB-24*	7-SL-SLSB-30*	7-SL-SLSB-36*
	96	8-SL-SLSB-24*	8-SL-SLSB-30*	8-SL-SLSB-36*
	108	9-SL-SLSB-24*	9-SL-SLSB-30*	9-SL-SLSB-36*
	120	10-SL-SLSB-24*	10-SL-SLSB-30*	10-SL-SLSB-36*

SUFFIX	DESCRIPTION
-C	Casters

Universal® Stainless Poly Top Tables



- Table frame fabricated from 1-1/2" square 16-ga. 300 Series stainless steel tubing
- Base fully-welded 1-5/8" stainless steel tubing legs and crossrails with stainless steel adjustable bullet feet
- 5/8" thick poly tops are sectional and removable per NSF standard No. 2 – and made of NSF and USDA approved high density polyethelene
- 6" backsplash and deck formed from one-piece stainless steel and welded
- Crossrails are 1-5/8" O.D. stainless steel tubing notched to fit legs and fully welded
- Undershelf is 18-ga. stainless steel with corners notched to fit legs and fully welded
- Ships fully welded and set up

UNIVERSAL POLYTOP TABLES FLAT TOP 16GA CROSSRAILS		WIDTH		
		24	30	36
LENGTH	48	4MCT-24	4MCT-30	4MCT-36
	60	5MCT-24	5MCT-30	5MCT-36
	72	6MCT-24	6MCT-30	6MCT-36
	84	7MCT-24	7MCT-30	7MCT-36
	96	8MCT-24	8MCT-30	8MCT-36

UNIVERSAL POLYTOP TABLES BACKSPLASH 16GA CROSSRAILS		WIDTH		
		24	30	36
LENGTH	48	4MCT-B24	4MCT-B30	4MCT-B36
	60	5MCT-B24	5MCT-B30	5MCT-B36
	72	6MCT-B24	6MCT-B30	6MCT-B36
	84	7MCT-B24	7MCT-B30	7MCT-B36
	96	8MCT-B24	8MCT-B30	8MCT-B36

UNIVERSAL POLYTOP TABLES FLAT TOP 16GA UNDERSHELF		WIDTH		
		24	30	36
LENGTH	48	4MCT-24U	4MCT-30U	4MCT-36U
	60	5MCT-24U	5MCT-30U	5MCT-36U
	72	6MCT-24U	6MCT-30U	6MCT-36U
	84	7MCT-24U	7MCT-30U	7MCT-36U
	96	8MCT-24U	8MCT-30U	8MCT-36U

UNIVERSAL POLYTOP TABLES BACKSPLASH 16GA UNDERSHELF		WIDTH		
		24	30	36
LENGTH	48	4MCT-B24U	4MCT-B30U	4MCT-B36U
	60	5MCT-B24U	5MCT-B30U	5MCT-B36U
	72	6MCT-B24U	6MCT-B30U	6MCT-B36U
	84	7MCT-B24U	7MCT-B30U	7MCT-B36U
	96	8MCT-B24U	8MCT-B30U	8MCT-B36U

Universal® Stainless Cabinet Base Tables



- Choose from open-front, sliding or hinged doors; flat top and 6" backsplash
- Includes one mid shelf
- Uni-body design includes die-formed rear and end panels welded to undershelves to achieve rigid one-piece unit
- Top 16-ga. 300 Series stainless steel – body and shelves are 18-ga. 300 Series stainless steel
- Legs: 6" high stainless steel with adjustable bullet feet
- Doors (if applicable) double pan, die formed and suspended with overhead track and ball bearing rollers with recessed pulls or hinged doors

UNIVERSAL CABINET BASE TABLE FLAT TOP 16GA		WIDTH	
		24	30
LENGTH	48	4CBT-24*	4CBT-30*
	60	5CBT-24*	5CBT-30*
	72	6CBT-24*	6CBT-30*
	84	7CBT-24*	7CBT-30*
	96	8CBT-24*	8CBT-30*
	108	9CBT-24*	9CBT-30*
	120	10CBT-24*	10CBT-30*

UNIVERSAL CABINET BASE TABLE BACKSPLASH 16GA		WIDTH	
		24	30
LENGTH	48	4CBT-24B*	4CBT-30B*
	60	5CBT-24B*	5CBT-30B*
	72	6CBT-24B*	6CBT-30B*
	84	7CBT-24B*	7CBT-30B*
	96	8CBT-24B*	8CBT-30B*
	108	9CBT-24B*	9CBT-30B*
	120	10CBT-24B*	10CBT-30B*

SUFFIX	DESCRIPTION
D	Sliding Doors
HD	Hinged Doors
-C	Casters



Universal® Stainless Mixer Stand

- Heavy-duty 16-ga. 300 Series stainless steel top
- Legs are made of 1-5/8" O.D. stainless steel tubing with adjustable bullet feet
- Undershef: 18-ga. stainless steel, notched to fit legs and fully welded
- Inverted "V" edge to contain equipment

MIXER STANDS 16GA		WIDTH	
		24	30
LENGTH	24	MS-24-S*	
	30	MS-2430-S*	MS-30-S*
	36	MS-2436-S*	MS-3036-S*

SUFFIX	DESCRIPTION
-C	Casters

Universal® Stainless Compartment Sinks

- Available in 16-ga. (N Series) or 14-ga. (SL-Series) 300 Series stainless steel construction
- Fully fabricated bowl with full metal thickness throughout for greater strength than a drawn sink
- 9" high integrally formed backsplash, with 2" return to wall at 45°
- 2 -1/2" high, 180° sanitary rolled rim at all free edges
- Leg assemblies are located directly under sink bowls for greater load support
- Legs are 1-5/8" diameter tubing with adjustable bullet feet
- Comes with basket drains and 1-1/8" faucet holes punched in backsplash on 8" centers as required
- NSF listed and CSA certified



SUFFIX	DESCRIPTION
18	Add 18" Drainboard
24	Add 24" Drainboard

UNIVERSAL 1COMP SINK 16GA		DRAINBOARD CONFIGURATION		
		NO DB	LD	RD
SINK BOWL SIZE	16x18	1N1618	1N1618-L*	1N1618-R*
	16x20	1N1620	1N1620-L*	1N1620-R*
	18x18	1N18	1N18-L*	1N18-R*
	18x24	1N1824	1N1824-L*	1N1824-R*
	20x20	1N2020	1N2020-L*	1N2020-R*
	20x28	1N2028	1N2028-L*	1N2028-R*
	24x24	1N24	1N24-L*	1N24-R*
	24x30	1N2430	1N2430-L*	1N2430-R*

UNIVERSAL 1COMP SINK 14GA		DRAINBOARD CONFIGURATION		
		NO DB	LD	RD
SINK BOWL SIZE	16x18	1SL1618	1SL1618-L*	1SL1618-R*
	16x20	1SL1620	1SL1620-L*	1SL1620-R*
	18x18	1SL18	1SL18-L*	1SL18-R*
	18x24	1SL1824	1SL1824-L*	1SL1824-R*
	20x20	1SL2020	1SL2020-L*	1SL2020-R*
	20x28	1SL2028	1SL2028-L*	1SL2028-R*
	24x24	1SL24	1SL24-L*	1SL24-R*
	24x30	1SL2430	1SL2430-L*	1SL2430-R*

UNIVERSAL 2COMP SINK 16GA		DRAINBOARD CONFIGURATION			
		NO DB	LD	RD	2D
SINK BOWL SIZE	16x18	2N1618	2N1618-L*	2N1618-R*	2N1618-2*
	16x20	2N1620	2N1620-L*	2N1620-R*	2N1620-2*
	18x18	2N18	2N18-L*	2N18-R*	2N18-2*
	18x24	2N1824	2N1824-L*	2N1824-R*	2N1824-2*
	20x20	2N2020	2N2020-L*	2N2020-R*	2N2020-2*
	20x28	2N2028	2N2028-L*	2N2028-R*	2N2028-2*
	24x24	2N24	2N24-L*	2N24-R*	2N24-2*
	24x30	2N2430	2N2430-L*	2N2430-R*	2N2430-2*

UNIVERSAL 2COMP SINK 14GA		DRAINBOARD CONFIGURATION			
		NO DB	LD	RD	2D
SINK BOWL SIZE	16x18	2SL1618	2SL1618-L*	2SL1618-R*	2SL1618-2*
	16x20	2SL1620	2SL1620-L*	2SL1620-R*	2SL1620-2*
	18x18	2SL18	2SL18-L*	2SL18-R*	2SL18-2*
	18x24	2SL1824	2SL1824-L*	2SL1824-R*	2SL1824-2*
	20x20	2SL2020	2SL2020-L*	2SL2020-R*	2SL2020-2*
	20x28	2SL2028	2SL2028-L*	2SL2028-R*	2SL2028-2*
	24x24	2SL24	2SL24-L*	2SL24-R*	2SL24-2*
	24x30	2SL2430	2SL2430-L*	2SL2430-R*	2SL2430-2*

UNIVERSAL 3COMP SINK 16GA		DRAINBOARD CONFIGURATION			
		NO DB	LD	RD	2D
SINK BOWL SIZE	16x18	3N1618	3N1618-L*	3N1618-R*	3N1618-2*
	16x20	3N1620	3N1620-L*	3N1620-R*	3N1620-2*
	18x18	3N18	3N18-L*	3N18-R*	3N18-2*
	18x24	3N1824	3N1824-L*	3N1824-R*	3N1824-2*
	20x20	3N2020	3N2020-L*	3N2020-R*	3N2020-2*
	20x28	3N2028	3N2028-L*	3N2028-R*	3N2028-2*
	24x24	3N24	3N24-L*	3N24-R*	3N24-2*
	24x30	3N2430	3N2430-L*	3N2430-R*	3N2430-2*

UNIVERSAL 3COMP SINK 14GA		DRAINBOARD CONFIGURATION			
		NO DB	LD	RD	2D
SINK BOWL SIZE	16x18	3SL1618	3SL1618-L*	3SL1618-R*	3SL1618-2*
	16x20	3SL1620	3SL1620-L*	3SL1620-R*	3SL1620-2*
	18x18	3SL18	3SL18-L*	3SL18-R*	3SL18-2*
	18x24	3SL1824	3SL1824-L*	3SL1824-R*	3SL1824-2*
	20x20	3SL2020	3SL2020-L*	3SL2020-R*	3SL2020-2*
	20x28	3SL2028	3SL2028-L*	3SL2028-R*	3SL2028-2*
	24x24	3SL24	3SL24-L*	3SL24-R*	3SL24-2*
	24x30	3SL2430	3SL2430-L*	3SL2430-R*	3SL2430-2*

Universal® Stainless Hand Sinks

- Choose from Standard Series (18-ga. deep fully fabricated bowl) or Spec Series (16-ga. 300 Series stainless steel, fully fabricated)
- 12" x 10" x 6" (305 x 254 x 152) bowl size
- 7" high integrally formed backsplash
- Inverted "V" non-drip edge on three sides
- Includes faucets, basket drains, and wall brackets
- Available with Electronic Eye option

Hand Sinks	
Drop In Hand Sinks With Faucets & Basket Drain	
DI-1-5DF	10 x 14 x 5
DI-1-10DF	10 x 14 x 10
Skirted Hand Sinks	
EHS-2	12 x 10 x 6
ADA Compliant Hand Sink With Wrist Handles	
HS-ADA	16 x 17 x 6



ISS® Glove, Hair Net, Face Mask Box Holder

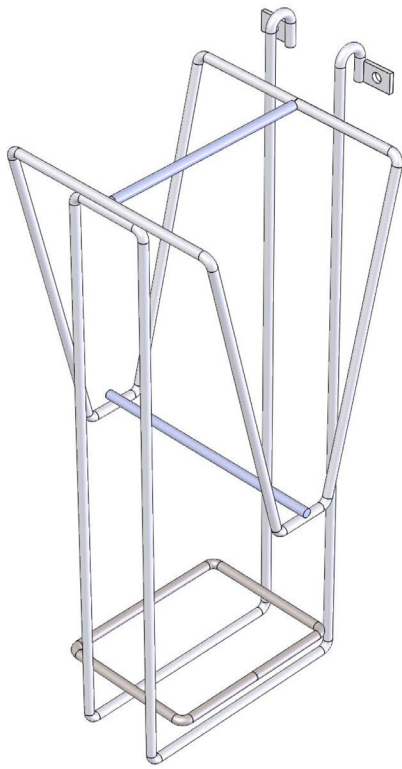

- Space at top holds 2 boxes with dimensions up to 3" x 5" x 9" each, and space at bottom holds 1 box measuring up to 3" x 4" x 4"
- Designed to hold face mask boxes, hair nets, glove boxes, or paper products.
- NSF listed and CSA certified
- Grey powder coated finish
- Holds items at point-of-use for easy accessibility
- Grid Mount, Wall Mount, and Wall Trax Mount Accessible

MODEL NUMBER

GBH359-344E

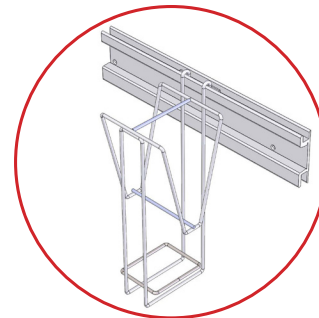

WALLTRAX MOUNTED

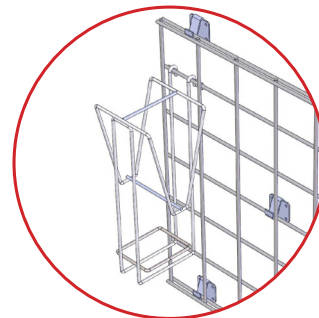

GRID MOUNTED

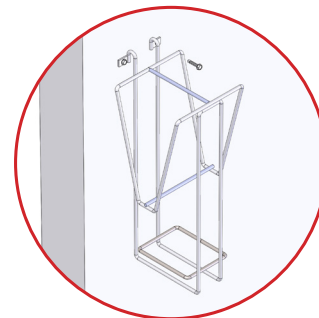

WALL MOUNTED

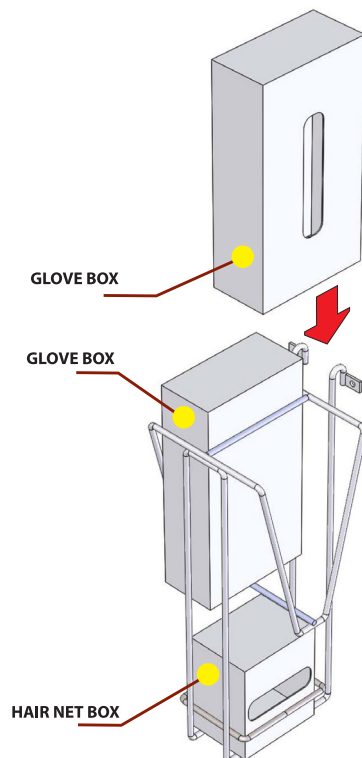

ISS® Wall Trax Accessories



Grid Baskets
GB12106*
GB12186*
GB12246*
GB18143*
GB3420*
GB4512*
GB6186*
GB994*

Grid Shelves			WIDTH	
LENGTH	Type	LENGTH	14	18
	GS	24	GS1424*	GS1824*
	GS	36	GS1436*	GS1836*
	GS	48	GS1448*	GS1848*
	GSS	24	GSS1424*	GSS1824*
	GSS	36	GSS1436*	GSS1836*
	GSS	48	GSS1448*	GSS1848*
	GSL	24	GSL1424*	GSL1824*
	GSL	36	GSL1436*	GSL1836*
	GSL	48	GSL1448*	GSL1848*

Grid Available Finishes	
Gold Bond	Y
Grey	E
Stainless Steel	S
Black (GRWM Only)	BLK

Grid Shelf Available Finishes	
Gold Bond	Y
Grey	E
Stainless Steel	S

ACCESSORIES

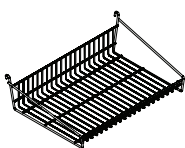

GSL1824E
GRID SHELF FLAT W/LIP

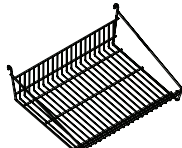

GSS1424E
GRID SHELF SLANTED

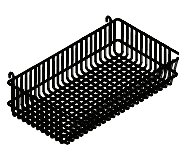

GB12246E
GRID BASKET

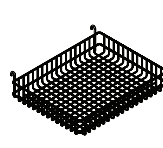

GB18143E
GRID BASKET

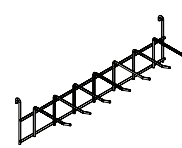

HOOK24E
24-IN. HOOK

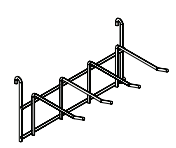

HOOK12E
12-IN. HOOK

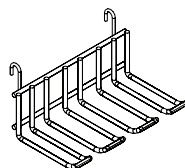

GRSCOOP
SCOOP HOLDER

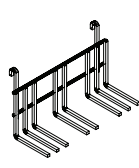

GRSPOODE
SPOODLE HOLDER

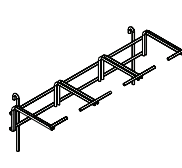

COFF3E
3-POT COFFEE HOLDER

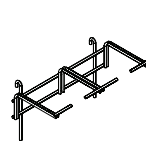

COFF2E
2-POT COFFEE HOLDER

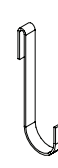

PHKE
POT HOOK GREY

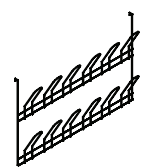

GRBTLHDE
GRID BOTTLE HOLDER



Maximizing efficiency, improving performance, getting more out of your people and your investment — it's what you must do every day to make your business more successful and more profitable. And it's what SPG helps you achieve through our extensive line of innovative food service equipment.

At SPG, our equipment is ergonomically designed to minimize the time, movement and effort of your staff— while maximizing the efficiency of every inch of your available space. We use the best materials for the job and manufacture to strict tolerances to ensure our equipment provides lasting performance and enduring value.

As a global company, we manufacture ISS, Kelmax, Freestyle and other quality storage product lines throughout North America and the Pacific. As a result, our products are delivered to businesses throughout the world every day...and every day we continue to deliver on our promise to ensure their continuing success and profitability.

CONTACT SPG

For SPG's complete product menu, visit spgusa.com or contact us:



877.503.4SPG (4774)



customerservice@spgusa.com



SPG International, LLC
World Headquarters
3340 Peachtree Rd Suite 1250
Atlanta, Georgia 30326